



PORT COLBORNE

PLANNING AND LEGISLATIVE SERVICES

COMMITTEE OF ADJUSTMENT NOTICE OF PUBLIC HEARING

File No. B01-24-PC

IN THE MATTER OF the Planning Act, R.S.O., 1990, c.P. 13, Section 53 (1).

AND IN THE MATTER OF the lands legally known as Plan 53 Part of Lot 4, New Plan 812, in the City of Port Colborne, located in the First Density Residential (R1) zone, municipally known as 105 Merritt Parkway.

IN THE MATTER OF by the applicant Pamela Koudijs, for consent to sever for the purposes of creating a new lot. The subject parcels are shown as Parts 1 and 2 on the proposed sketch, where Part 1 is to be severed for a new residential use and Part 2 is to be retained for an existing residential use. A sketch of the subject lands is shown on the reverse side of this notice.

LOCATION MAP

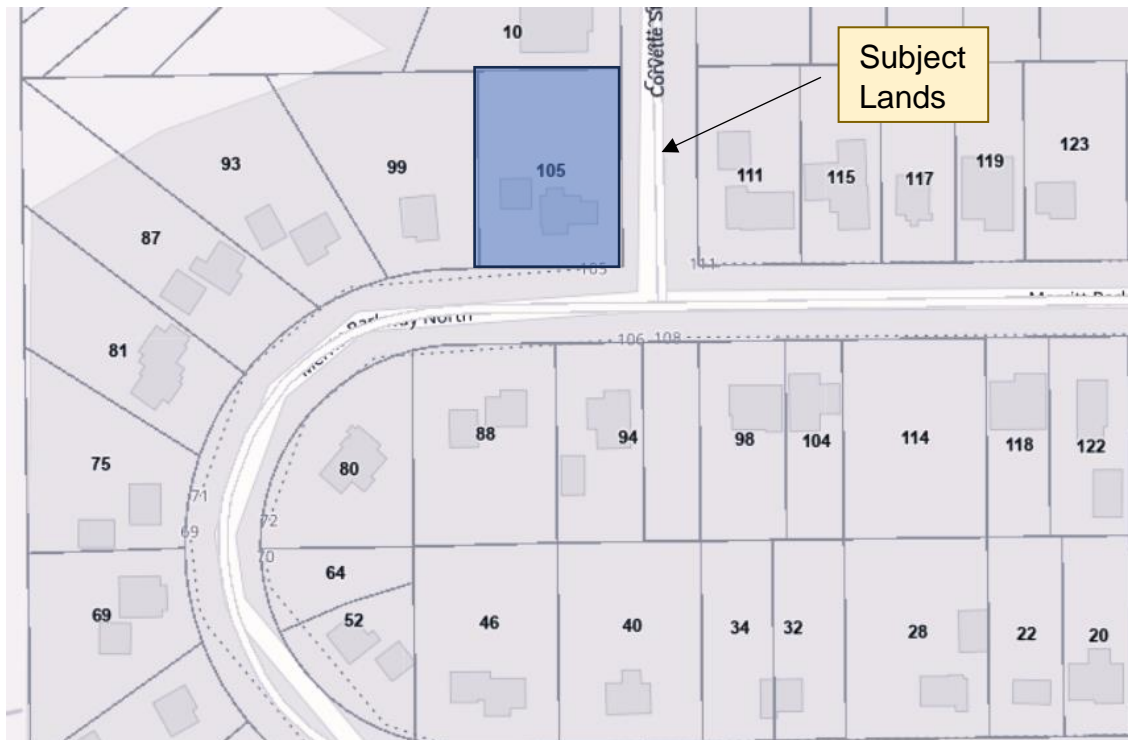

PLEASE TAKE NOTICE that this application will be heard in-person and virtually by the Committee of Adjustment as shown below:

Date: February 14th, 2024

Time: 6:00 P.M.

Location: 66 Charlotte Street – Third Floor Council Chambers and Virtually via Zoom

Additional information regarding this application will be available for public inspection. An appointment can be scheduled in the office of the Planning and Development department, Monday to Friday, during the hours of 8:30 A.M. to 4:30 P.M., by telephone at 905-835-2900, ext. 204, or through email at taya.taraba@portcolborne.ca.

PUBLIC HEARING: You are entitled to participate and express your views about this application, or you may be represented by counsel for that purpose. The Planning Division's report may be available for public inspection by Friday, February 9th, 2024.

NOTE: If you are receiving this notice as the owner of land that contains multiple residential units, please post this in a location that is visible to all tenants.

Electronic Hearing Procedures
How to Get Involved in the Virtual Hearing

The meeting will be held both publicly, in-person, and through a livestream on the City's YouTube channel.

Anyone wishing to participate in the meeting can attend either virtually or in-person and is encouraged to submit a written submission that will be circulated to the Committee of Adjustment prior to the meeting. This entry will, eventually, become accessible to the public. If anyone wishes to orally participate in the meeting, they must pre-register with the Secretary-Treasurer. **Written submissions and participation requests must be received by 12 P.M. Tuesday, February 13, 2024**, by emailing taya.taraba@portcolborne.ca or by calling (905) 835-2900 ext. 204. Written submissions may also be submitted to the mail slot located in the front-left of City Hall; 66 Charlotte Street.

If you have any questions about the submission process or would like to explore alternative submission methods, please email taya.taraba@portcolborne.ca or call (905) 835-2900 ext. 204.

The owner or agent must be present, either in person or virtually, at the Hearing. If you do not attend the Hearing, the Committee may adjourn the file or proceed in your absence and come to a decision. If you wish to be notified of the decision of the Committee of Adjustment in respect to this application, you must submit a written request to the Secretary-Treasurer. This will also entitle you to be advised of a possible Ontario Land Tribunal Hearing. In accordance with the *Planning Act*, the Committee of Adjustment's decision may be appealed to the Ontario Land Tribunal by the owner, the Minister of Municipal Affairs and Housing, a specified person or public body that has an interest in the matter.

By order of the Committee of Adjustment,

Date of Mailing: January 29th, 2024

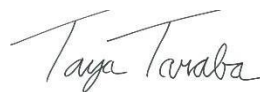

Taya Taraba
Secretary-Treasurer

SKETCH

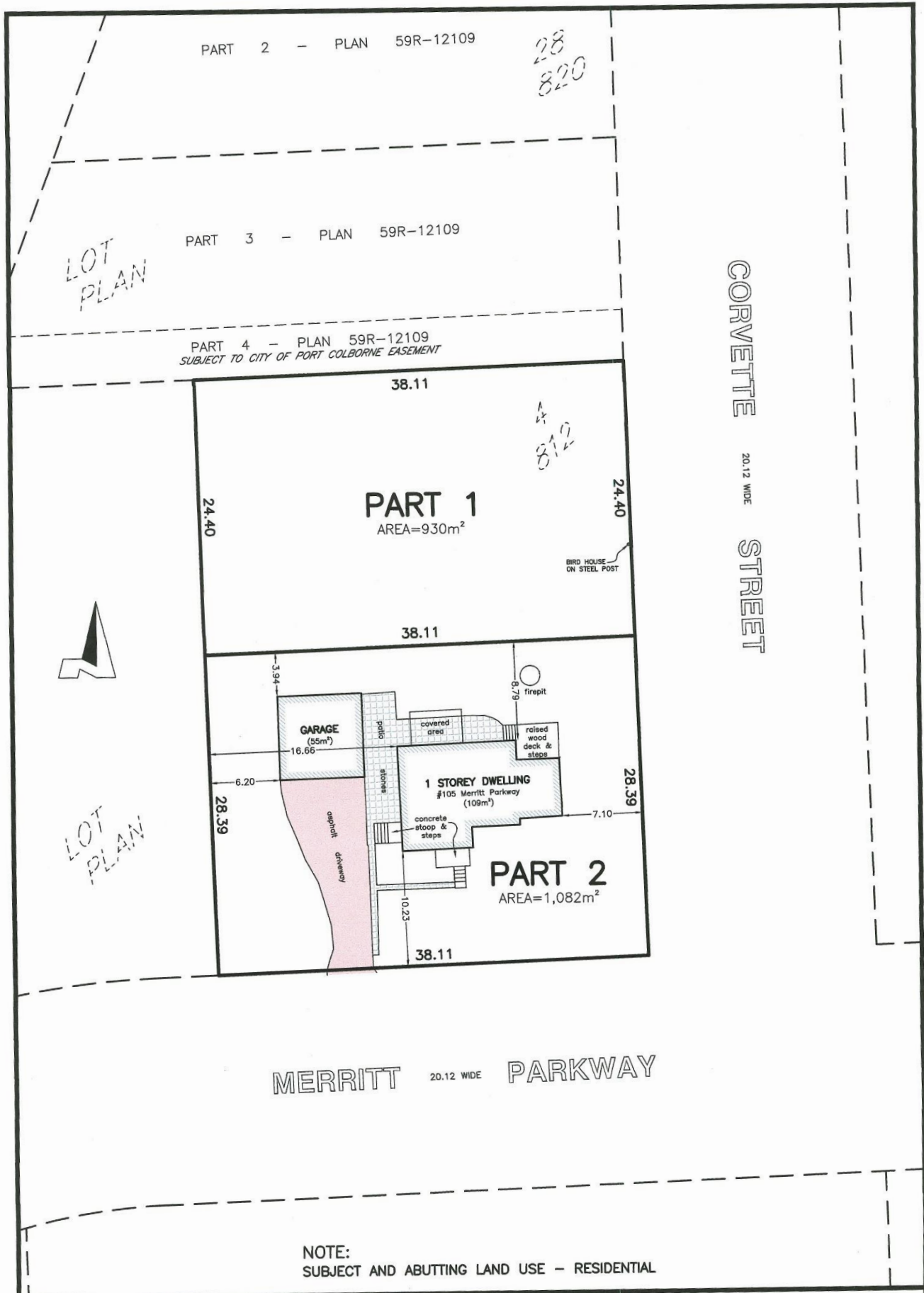

NOTE:
SUBJECT AND ABUTTING LAND USE - RESIDENTIAL

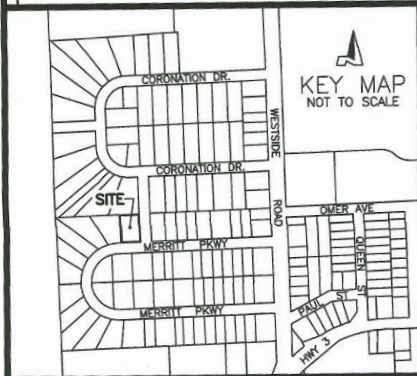

SKETCH
PREPARED FOR CONSENT APPLICATION
PART OF LOT 4
PLAN 812
IN THE
CITY OF PORT COLBORNE
REGIONAL MUNICIPALITY OF NIAGARA
SCALE 1 : 400 (METRIC)

NOTE: THIS SKETCH IS PREPARED FROM COMPILED AND CALCULATED INFORMATION, NOT FROM AN ACTUAL SURVEY.
DO NOT SCALE FROM THIS DRAWING.
ALL MEASUREMENTS ARE +/- MEASUREMENTS.

CAUTION: THIS IS NOT A PLAN OF SURVEY AND SHALL NOT BE USED EXCEPT FOR THE PURPOSE INDICATED IN THE TITLE BLOCK.
"THIS IS NOT AN ORIGINAL COPY UNLESS EMBOSSED WITH SEAL."

© COPYRIGHT 2023
THE REPRODUCTION, ALTERATION OR USE OF THIS SKETCH, IN WHOLE OR IN PART WITHOUT THE EXPRESS WRITTEN PERMISSION OF CHAMBERS AND ASSOCIATES SURVEYING LTD. IS STRICTLY PROHIBITED.

Nov. 30, 2023 *Don Chambers*
DATE DONALD G. CHAMBERS, B. Sc., O.L.S.

CHAMBERS AND ASSOCIATES SURVEYING LTD
12 THOROLD ROAD EAST (905) 735-7841 / 735-7844
WELLAND ONTARIO FAX (905) 735-7333
L3C 3T2 www.cast-surveying.com

DWG 87090-6_SEV FILE 87-90-6